

Certification of Ownership and Dedication  
 I (we) hereby certify that I am (we are) the owner(s) of the property shown and described hereon and that I (we) hereby adopt this subdivision plat with my (our) free consent, establish the minimum building restriction lines, and dedicate all streets, alleys, walks, park or other public ways and open space to public or private use as noted.

Date \_\_\_\_\_ Owner \_\_\_\_\_  
 Date \_\_\_\_\_ Owner \_\_\_\_\_

Certificate of Accuracy  
 I hereby certify that this survey was completed in compliance with Tennessee Minimum Standards of Practice and that this is a category "T" survey and the ratio of precision of the unadjusted survey is 1:10,000 or better as shown hereon.  
 This is to certify that I have consulted the federal insurance administration flood hazard boundary map and the property shown is not located in a special flood hazard area, unless otherwise noted.

11/6/14  
 Date *Timothy J. Howell*  
 Timothy J. Howell RLS #2263

NUM	DELTA	ARC	RADIUS	BEARING	DISTANCE
C1	5°16'00"	36.77'	400.00'	S61°49'34"W	36.75'
C2	3°07'38"	272.45'	4992.55'	S66°01'23"W	272.45'
C3	24°48'11"	134.55'	311.21'	S55°11'51"W	133.54'
C4	3°19'59"	273.22'	4696.77'	S43°13'49"W	273.18'
C5	15°40'54"	164.23'	600.02'	S52°44'16"W	163.71'
C6	7°49'50"	105.92'	775.01'	S56°39'50"W	105.84'
C7	12°50'02"	100.80'	450.01'	S59°09'56"W	100.59'
C8	4°18'04"	42.46'	565.65'	S63°25'57"W	42.45'
C9	78°01'44"	34.05'	25.00'	N79°42'18"W	31.48'
C10	8°47'01"	374.22'	2441.08'	N06°17'58"W	373.86'
C11	60°23'39"	79.05'	75.00'	N1°42'41"E	75.44'
C12	37°26'36"	375.76'	575.00'	N8°45'47"E	369.11'
C13	4°31'42"	953.88'	12068.90'	N11°13'21"W	953.63'
C14	5°46'10"	148.84'	1478.13'	N10°38'06"W	148.78'
C15	8°50'26"	144.60'	937.11'	N12°08'12"W	144.45'

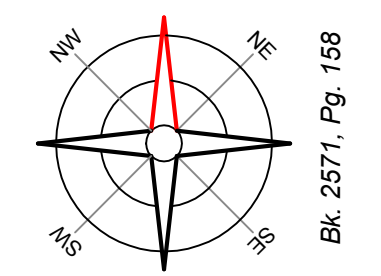
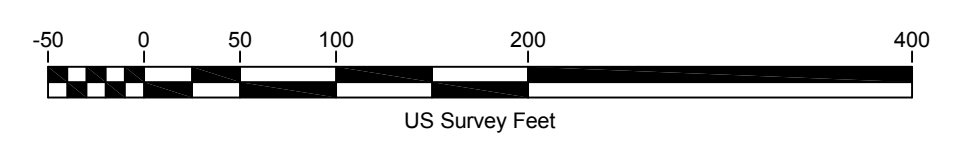

Notes:  
 ▲ Existing Iron Pin  
 ● 1/2" Iron Pin  
 ○ Calculated Point  
 This section not provided. Other easements, encroachments, etc. may exist and not be shown.

Survey of the Lane Hollow Property for  
**Ronald W Ogle**  
 and  
**Betty M Ogle**

Timothy J. Howell, RLS 2263  
 (865) 742-2557  
 Office Fax (865) 674-8118  
 121 Dorothy Drive Talbott, TN 37877  
 tm@intids.com

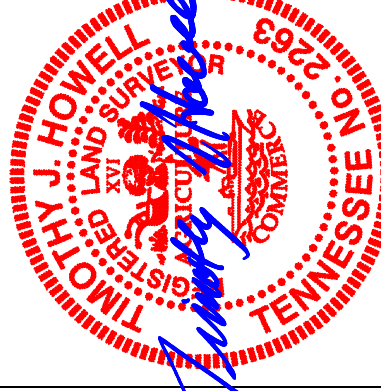

Showing property of Ogle, et ux, et al.  
 Located in the 4th civil district of Sevier County, Tennessee.  
 For source of file, see Wdb. 2571, Pg. 158  
 Tax Map 51 Parcel 2.00 Map Bk. 21, Pg. 81  
 November 4, 2014 Scale: 1" = 100'  
 Project: Lane & Walnut  
 Drawn: Ron Ogle